



Storagewall

A highly adaptable, modular system that can be easily configured to suit the confines of any space.

Spacestor®

Signature

A highly adaptable, modular office storage system that can be easily reconfigured

Variations



Doors Module - Low
SWS-FHD-L



Doors Module - Low
SWS-FHD-L



Doors Module - High
SWS-FHD-H



Doors Module - High
SWS-FHD-H



Split Door Module
SWS-DDR



Doors & Display Module
SWS-DDS

Dimensions

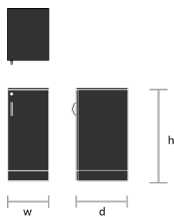

Doors Module - Low

Depth: 20"
Height: 36"
Widths: 16"/20"/24"

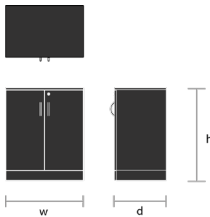

Doors Module - Low

Depth: 20"
Height: 36"
Widths: 30"/36"/42"/48"

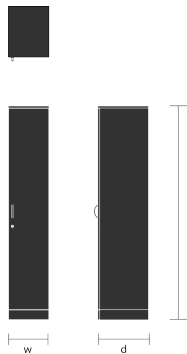

Doors Module - High

Depth: 20"
Height: 84"
Widths: 16"/20"/24"

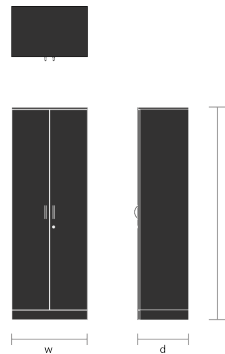

Doors Module - High

Depth: 20"
Height: 84"
Widths: 30"/36"/42"/48"

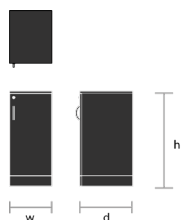

Split Doors Module

Depth: 20"
Height: 84"
Widths: 36"/42"/48"

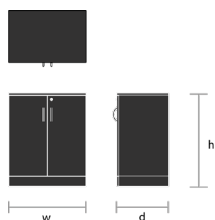

Doors & Display Module

Depth: 20"
Height: 84"
Widths: 36"/42"/48"

Technical Specification

- 18½" deep internal, 20" external
- ¾" thick panel construction
- On full height units cabinets have one fixed shelf for stability
- 4" base with adjustable glides
- Soft close hinges
- Bow handle and keyed lock as standard
- Adjustable shelves on 16" centers
- Finished top as standard
- Unfinished side clads as standard
- Unfinished back panel as standard
- Adjustable floor glides for levelling
- EPD and HPD certification available

Customizable Options

- Custom heights, widths and depths are available
- Vast range of finish options available
- Additional internal accessories available
- Additional lock options available
- Split height doors
- Finished back panels
- Wall and ceiling scribes
- Seismic anchor kits available on request

Snugglestor

An upholstered alcove with ultimate design appeal, for offices with personality.

Variations



Single
SGS-HBS



Double
SGS-HBD



Backless Single
SGS-HOS



Backless Double
SGS-HOD

Dimensions

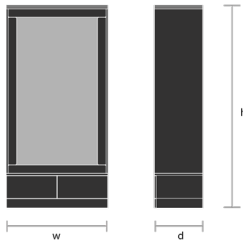

Single

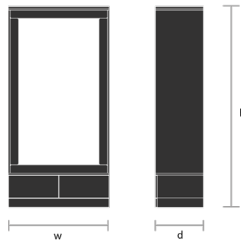

Double

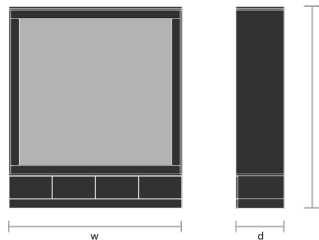

Backless Single

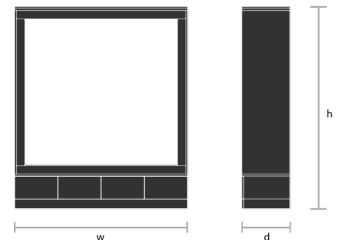

Backless Double

Depth: 20"
Heights: 84"
Widths: 42"/48"

Depth: 20"
Heights: 84"
Widths: 72"/84"

Depth: 20"
Heights: 84"
Widths: 42"/48"

Depth: 20"
Heights: 84"
Widths: 72"/84"

Technical Specification

- ¾" thick panel construction
- On full height units cabinets have one fixed shelf for stability
- Finished top as standard
- Unfinished side clads as standard
- Unfinished back panel as standard

- Adjustable floor glides for levelling
- Upholstery complies with CA TB 117-2013 and SB 1019
- EPD and HPD certification available
- Fixed panel beneath seat

Customizable Options

- Custom heights, widths and depths are available
- Vast range of finish options available
- Finished back panels
- Wall and ceiling scribes
- Seismic anchor kits available on request
- Storage above unit

Trashpoints

Designer, customisable, recycling and printing stations for all workplace waste management, recycling and print station needs.

Variations



Low Waste Module
RYS-WML



High Waste Module
RYS-WMH



Single Trashpoint
RYS-WPS



Single Trashpoint
RYS-WPD

Dimensions

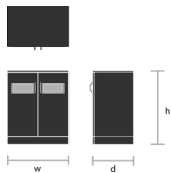

Low Waste Module

Depth: 20"
Heights: 36"
Widths: 30"/36"/48"

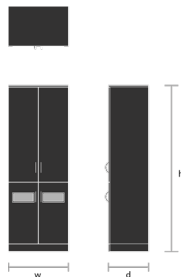

High Waste Module

Depth: 20"
Heights: 84"
Widths: 30"/36"/48"

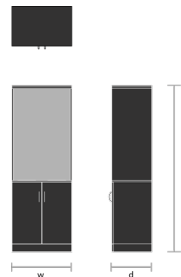

Single Trashpoint

Depth: 20"
Heights: 84"
Widths: 30"/36"/48"

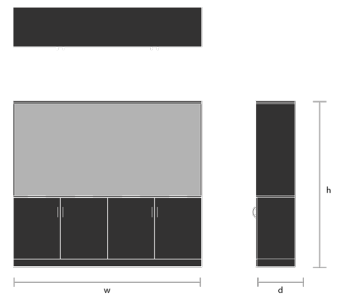

Double Trashpoint

Depth: 20"
Heights: 84"
Widths: 72"/84"/96"

Technical Specification

- 18½" deep internal, 20" external
- ¾" thick panel construction
- On full height units cabinets have one fixed shelf for stability
- 4" base with adjustable glides
- Soft close hinges
- Bow handle included
- Adjustable shelves on 16" centers
- Finished top as standard
- Unfinished side clads as standard
- Unfinished back panel as standard
- Adjustable floor glides for levelling
- EPD and HPD certification available

Customizable Options

- Custom heights, widths and depths are available
- Vast range of finish options available
- Additional internal accessories available
- Additional lock options available
- Split height doors
- Finished back panels
- Wall and ceiling scribes
- Seismic anchor kits available on request

Teapoint

Attract and retain top talent with quality refreshment facilities.

Variations



Wakeup
TPS-WAK



Breakout
TPS-BKO



Breakout Plus
TPS-BKP

Dimensions

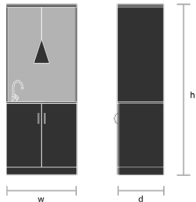

Wakeup

Depth: 23½"
Heights: 84"
Widths: 36"/42"/48"

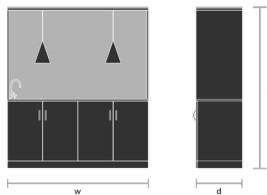

Breakout

Depth: 23½"
Heights: 84"
Widths: 72"/84"/96"

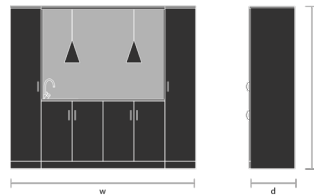

Breakout Plus

Depth: 23½"
Heights: 84"/96"/108"
Widths: 96"/120"/144"

Technical Specification

- 22" deep internal, 23½" external
- ¾" thick panel construction
- 4" base with adjustable glides
- On full height units cabinets have one fixed shelf for stability
- Soft close hinges
- Bow handle included
- Adjustable shelves on 16" centers
- Finished top as standard
- Unfinished side clads as standard
- Unfinished back panel as standard
- Adjustable floor glides for levelling
- EPD and HPD certification available
- All splashback/sink/faucet/lighting not included as standard in these Variations

Customizable Options

- Custom heights, widths and depths are available
- Vast range of finish options available
- Additional internal accessories available
- Additional lock options available
- Split height doors
- Finished back panels
- Wall and ceiling scribes
- Seismic anchor kits available on request

Mediastor

Media-integrated storage for a professional presentation.

Variations



Single
MES-DAS



Double
MES-DAD

Dimensions

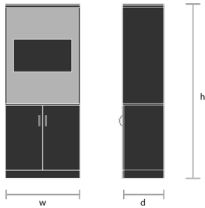

Single

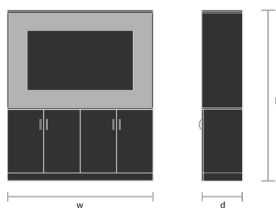

Breakout

Depth: 20"
Heights: 84"
Widths: 30"/36"/48"

Depth: 20"
Heights: 84"
Widths: 72"/84"/96"

Technical Specification

- 18½" deep internal, 20" external
- ¾" thick panel construction
- 4" base with adjustable glides
- Soft close hinges
- Bow handle included
- Adjustable shelves on 16" centers
- Single height door
- Finished top as standard
- Finished side clads as standard
- Unfinished back panel as standard
- Adjustable floor glides for levelling
- EPD and HPD certification available

Customizable Options

- Custom heights, widths and depths are available
- On full height units cabinets have one fixed shelf for stability
- Vast range of finish options available
- Additional internal accessories available
- Additional lock options available
- Split height doors
- Finished back panels
- Wall and ceiling scribes
- Seismic anchor kits available on request

Handles & Locks

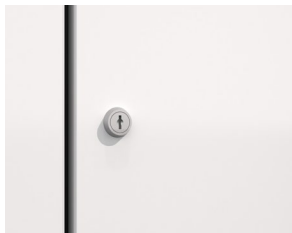

Flush Keylock Silver/Black
RN1

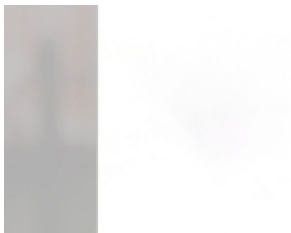

Push Catch
PCS

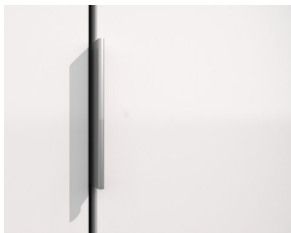

Tab Pull
TP1



Bow Handle
SR8

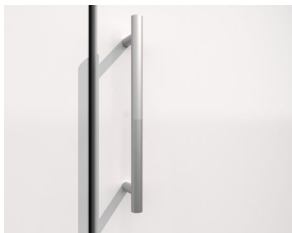

T-bar Handle
TB1



Knob
SR9

Finishes

- **Lacquered Plywood**
- **LPL Group 1:** White
- **LPL Group 4:** Black, Fog Grey, Hardrock Maple
- **LPL Group 5:** Arctic Groovz, Cotton White, Pelee Island Pear, Rogue Valley Pear, Willow, Charcoal, Storm, Talas Cherry
- **LPL Groups 6:** Ashen, Celadon, Duke, Linear Ash, Mist, Mysterious, Noce Vettore, Roja, Sienna, Verde, Adobe, Enigma, Karuna Ash, Quarry
- **LPL Groups 7:** Alabaster, Ginger
- **HPL Group 1:** Frosty White, Black, Natural Maple
- **HPL Group 2:** Brite White, Designer White, Dove Gray, Citadel, Pewter, Graphite, Navy Blue, Blueberry Taffy, Matrix Blue, Winter Sky, Cassis, Spectrum Red, Clementine, Chrome Yellow, Fossil, Spectrum Green, Finnish Oak, Danish Maple, Oiled Walnut, Earthenware, Oyster Gray, Pumice, Carbon Mesh
- **HPL Group 3:** Otter, New Burgundy, Just Rose, Fawn Cypress, Millennium Oak, Neowalnut, Walnut Heights, Blackened Legno, Field Elm, White Ash, Blush, Green Slate Ash
- **HPL Group 4:** Bleu Rada, Azzuro Pervinca, Verde Lauro, Rosso Lord, Dark Verde Oliva

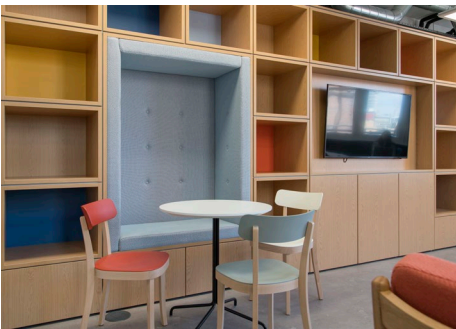
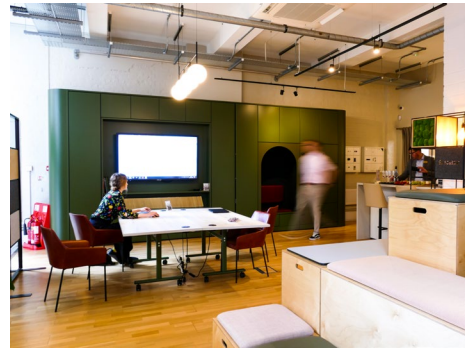
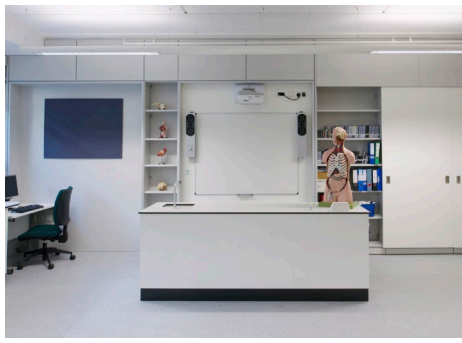

CALIFORNIA COOL



LONDON DESIGN

LA: (310) 410-0220
NY: (212) 457-1664
us.sales@spacestor.com
www.spacestor.com